

Alwa-Comfort

Honeywell



The way ahead
The first in-line floor level regulating valve

Alwa-Comfort: Regulation and hygiene perfectly in-line

The revolutionary Alwa-Comfort is the first regulating valve featuring an in-line, fully submersed thermal element which offers precise control of hot water. The minimal flow rate is defined via its patented bypass function and the valve points the way ahead in individual floor level temperature control in multi-dwelling buildings.

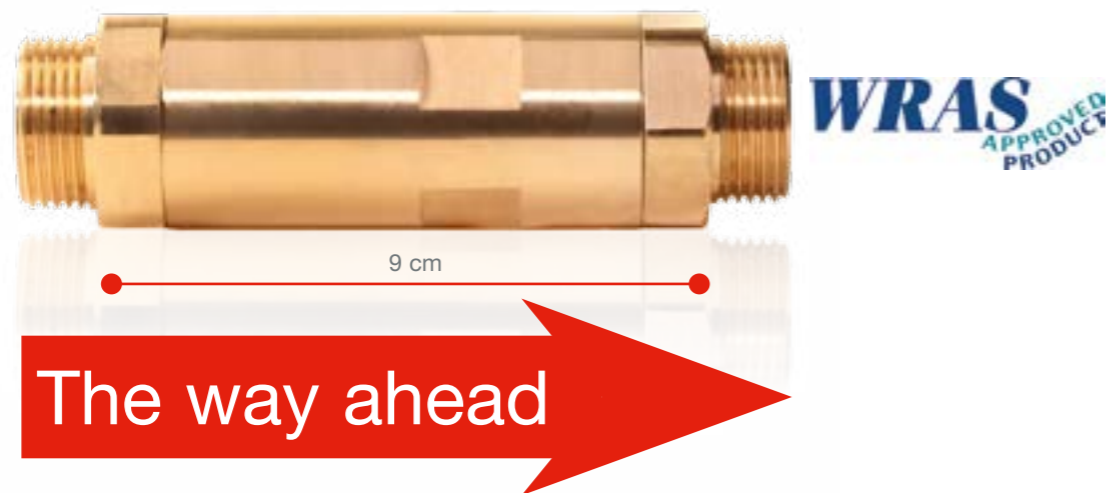

The first in-line individual floor level regulating valve featuring a submersed thermal element

Exact Control

A key feature of the in-line design is the fully submersed thermal element which delivers accurate temperature control of individual floor levels.

The Alwa-Comfort is pre-set to either 57 or 63 °C and the thermal element constantly holds that temperature.

Ensuring Water Hygiene

Given that cell growth for legionella is estimated to double every 50 – 60 minutes, thermal disinfection at 70 °C is necessary. Disinfection is possible without a break in hydraulic balancing and the valve may be used in warm potable water systems where the highest hygienic standards are required.

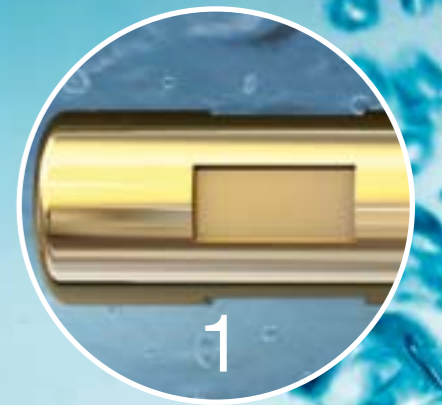

The built-in, fully submersed thermal element allows for the highest degree of accuracy.

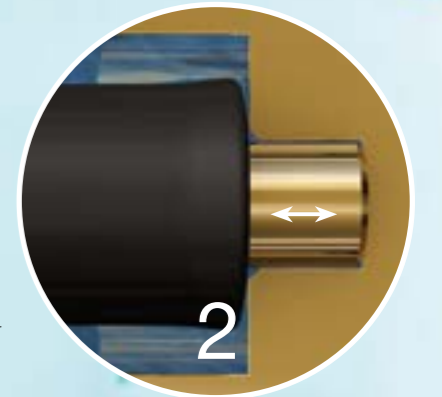

An increase in temperature causes the thermal element to expand and gradually close the valve. A reduction in temperature causes the reverse and the valve again allows the in flow of heated water.

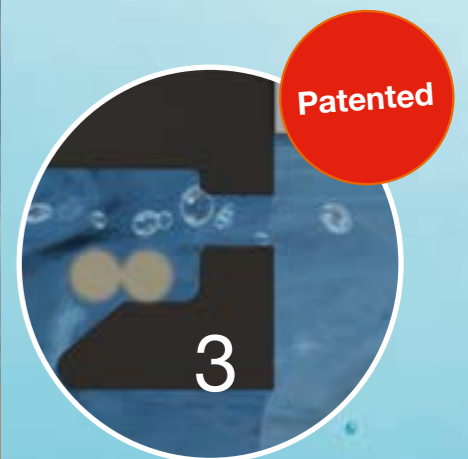

Via the patented bypass opening in the valve, the minimum flow rate is defined.

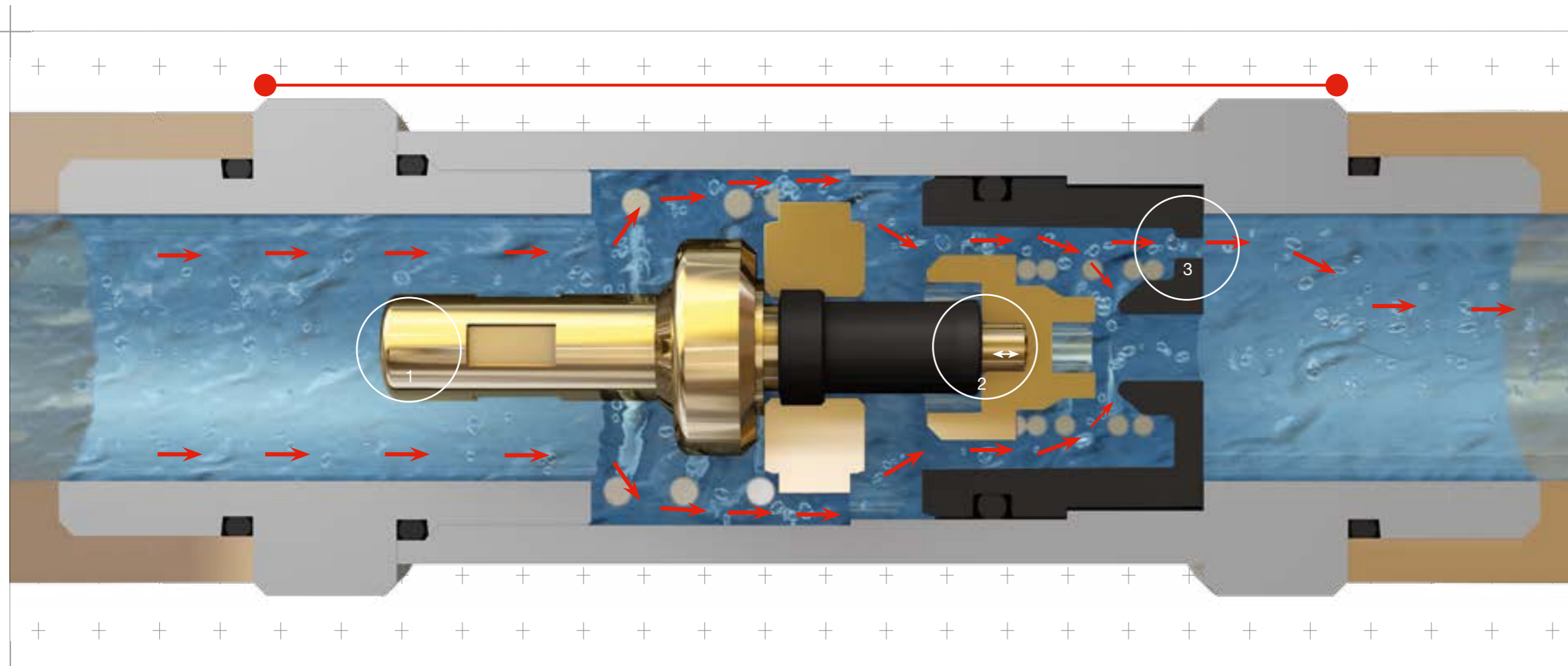

The way ahead: Planning and installation

With the Alwa-Comfort Honeywell offers an in-built, floor level regulating valve, providing the ultimate in hot water system design.

Thanks to its revolutionary in-line design, the product is small and space saving while offering simple installation and insulation. The pre-set temperatures of 57 or 63 °C, means no additional adjustment or control is required.

Due to its minimal flow volume of < 0.1 m³/h, the Alwa-Comfort is used for individual floor levels and other smaller heating circuits to control the hot water circuit. One of the major advantages of the valve is when you want hot water distributed around the circulation system hygienically and at the correct temperature, on demand.

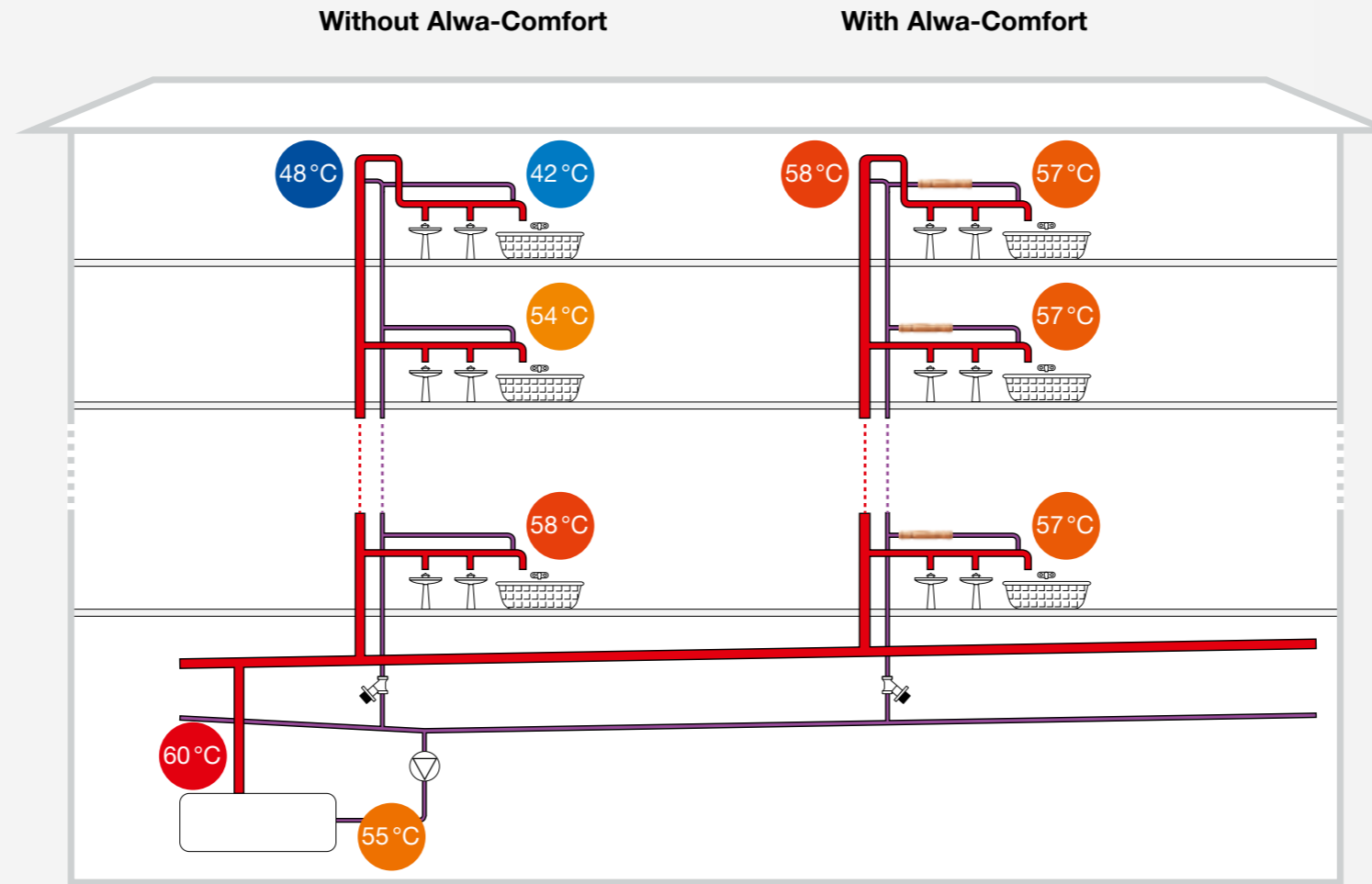

The chart below shows the characteristic curve where Alwa-Comfort is pre-set at 57 °C. Tested at the nominal size DN15 the valve shows the required minimum flow rate of 0.6 m³/h.

Also, the requirement for the minimal flow rate of 0.1 m³/h is achieved. Alwa-Comfort is the way forward for individual floor level temperature control by a regulating valve.

Alwa-Comfort characteristic

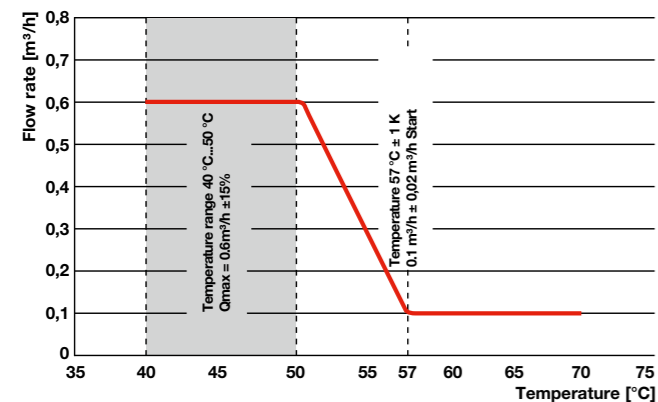

Way ahead advantages for specifiers and installation personnel

- Fulfills the requirements for good system design and reliability in use
- The in-line design allows for ease of installation and space saving
- The housing is made of corrosion resistant red brass
- Highest degree of accuracy thanks to the built-in, fully submersed thermal element
- All materials in contact with water comply with WRAS
- Via the patented bypass opening in the valve, the minimum flow rate is defined
- Cavitation free due to the use of plastic valve seat



Way ahead: The complete range



Alwa-Comfort – Standard version (AP)

The Alwa-Comfort is a hydraulic balancing regulating valve for individual floor levels. Being pre-set at 57 or 63 °C the valve opens and closes automatically and regulates with great accuracy as a reaction to temperature changes. A fall in temperature causes the valve to open and allows the in-flow of domestic hot water whereas a rise in temperature closes the valve. When closed, a minimal pre-set flow continues until the circulating water reaches its pre-set temperature, therefore achieving a permanent balancing of the circulating water temperature with the minimum of energy expenditure.

The Alwa-Comfort Standard version is supplied either with or without a ball valve and connection is by internal or external threads, or soldered fit.

The product housing is made of corrosion resistant red brass and all components in contact with water are approved for drinking water use according to WRAS.

The valve seat is manufactured from synthetic material and protects the unit from cavitation or other mechanical damage. Due to its simplicity of design the product is robust and maintenance free.

The Alwa-Comfort – Behind the wall version

The behind the wall version of Alwa-Comfort is essentially the same as the standard version but is supplied with an insulation shell.



Alwa-Sampling Valve

A valve for all methods of sample extraction. The valve may be installed vertically or horizontally and is easy to use. The outlet pipe is made of stainless steel, rotatable through 360° and may be flame sterilised.

Technical data

Medium	Water
Operating temperature	max. 90 °C
Operating pressure	max. 10 bar
$k_{v,min}$ -Value	max. 0.1 m ³ /h
$k_{v,max}$ -Value	min. 0.6 m ³ /h
$k_{v,TD}$ -Value	≤ 0,1 m ³ /h
Connection size	DN 15



Alwa valves – a product family with connections

Alwa-Kombi-4

The Kombi 4 is a thermostatic balancing valve for hot water circulation systems. Installed in the return pipework and equipped with a thermal actuator, the Kombi 4 will control return water temperatures and will automatically support thermal disinfection.

The valve will close to a leakage rate when the water temperature reaches set point, therefore providing dynamic balancing for the water system.

A thermostatic actuator can control the return water temperature, allowing a thermal disinfection cycle. With a combined throttle and shut off facility, there is no need for additional isolation valves. A separate drain adapter can be used as a drain off point, and with an additional thermometer the circulation temperature can be clearly displayed.

The Alwa-Comfort is the newest, innovative product in the Alwa range. All Alwa valves are specifically designed for the usage in potable water applications.



In addition to Balancing Valves, Honeywell offers a complete range of water controls for the protection and control of potable water.

Experts in the provision of:

Pressure Reducing Valves
Thermostatic Mixing Valves
Backflow Preventers
Water Filters
Control Valves
Strainers

Check out the full range of Honeywell Water Controls. Download this brochure from www.honeywellukwater.com or scan the QR code.



Honeywell Control Systems Ltd

Honeywell House
Skimped Hill Lane, Bracknell
Berkshire RG12 1EB
Tel: 01344 656000
Fax: 01344 656240
E-Mail: water.control@honeywell.com
www.honeywellukwater.com



EN3H-3133UK01 R0613
Subject to change without notice
©2013 Honeywell International Inc. All rights reserved.